



Seagoing launch
"COASTAL ASSISTANT"

522 KWT / Bathymetric survey

ENKA İNŞAAT VE SANAYİ A.Ş.

No.1, S. Zhangabyly, Bautino, 130502, Tupkaragan
Region, Mangistau Oblast, Republic of Kazakhstan
Phone: +7 72938 24 808, Fax: +7 72938 24 000
marine@enka.com
www.enka.com

SHIP SPECIFICATION "COASTAL ASSISTANT"

CLASS AND FLAG DATA

Type	Seagoing launch
Year built / Shipyard	1986, the Netherland
Class	BV
Class symbol	I • HULL • MACH Seagoing launch
Flag	Kazakhstan
Port of registry	Aktau
Call sign	OUX
IMO number / or <u>Class number</u>	942C55

DIMENSIONS

Length (overall)	18,49 m
Breadth (moulded)	6,0 m
Depth (moulded)	1,54 m
Draft (summer)	1,45 m
Minimal operational draft	1,35 m
Registered gross tonnage	51

MACHINERIES

Main engines	2x294 kW
Auxiliary diesel-generators	Perkins 21 KW
Emergency diesel-generator	Lister 24 KW
CPP / FPP and Rudder(s)	twin screw fix. pitch prop. rudders
Steering gear	PROMAS STUWA TYPE:2C2LZ80/40-40055

AUXILIARY EQUIPMENT

Survey equipment	Can be provided as necessary
------------------	------------------------------

ANCHOR AND MOORING EQUIPMENT

Anchor windlass	1 (ATELIERS L.VANLIER 1501)
Anchors	1(120 KG)
Chains (length, caliber)	150 m/ 20mm
Capstan	1 hydraulic

TANKS FULL CAPACITIES

Fuel tanks	10,261 m ³
Fresh water tanks	2 x 0,4 m ³
Sewage water tanks	0,8 m ³
Oily bilge water tanks	0,4 m ³
Ballast water tanks	1,032 m ³

TRANSFER RATES

Sewage water	2,0 m ³ per 1 hr
Oily bilge water	0,406 m ³

DECK CAPACITY

Clear deck area	5 m ²
-----------------	------------------

DECK CRANE(S)

Manufacturer	HIAB FOCO
SWL	1m - 1t, 7m - 550 kg
Location	Deck SB

PERFORMANCE

Maximum speed / consumption	10/1,6 kts/tones
Economical speed / consumption	8/1,2 kts/tones
Bollard pull	8

**All the details are believed to be correct but not guaranteed and owners reserve the right to amend them*

SHIP SPECIFICATION "COASTAL ASSISTANT"

NAVIGATION AND COMMUNICATION

GMDSS area	[A1+A2+A3]
INMARSAT station	SAILOR 250 FleetBroadband"
Radar 1	FURUNO FR-8050DA
AIS	NAUTICAST X-PACK DS
EPIRB	McMurdo Wessex E3
Radar transponder	(McMurdo)
VHF radio station	2x 70CH WKR FURUNO FM- 8500
MF/HF radio station	ICH DSC WKR FURUNO FS-1562-15
Two-way portable VHF	3x SAMYUNG STV-160
Magnetic compass	CASSENS & PLATH
Auto pilot	(INA Rotterdam /Autopilot DP 200)
NAVTEX receiver	FURUNO NX-500
GPS receiver	SAMYUNG SPR-1400
Echo sounder	KODEN CVS-118-MKII

FIREFIGHTING EQUIPMENT AND POLLUTION PREVENTION EQUIPMENT

Portable fire extinguishers	8
Fire hoses and nozzles	2 fire hoses, 2 nozzles
Fire pump	1
Emergency fire pump	1
Fixed fire-fighting system	CO ₂
Oil spill kit	1

LIFE-SAVING APPLIANCES

Inflatable life raft	1 x 12, 1 x 10
Life buoy	6
Life jacket	9 + additional if necessary
Immersion suit	7 + additional if necessary
Markus net	1

ACCOMMODATION

Number of crew for safe operation / passengers	3 at twelve hours shift / 10 for short voyages only
One-bed cabin	3

TANK NAME

100% CAPACITY

Fuel day tank SB. PS	0,908 m ³
Fuel side tank SB. PS	2,031m ³
Fuel mid tank	4,383 m ³
Fresh water tank PS SB	0,4 m ³
Sewage tank PS SB	0,4 m ³
Bilge oil water tank	0,4 m ³

**All the details are believed to be correct but not guaranteed and owners reserve the right to amend them*

SHIP SPECIFICATION "COASTAL ASSISTANT"

m/v Coastal Assistant

GENERAL ARRANGEMENT PLAN

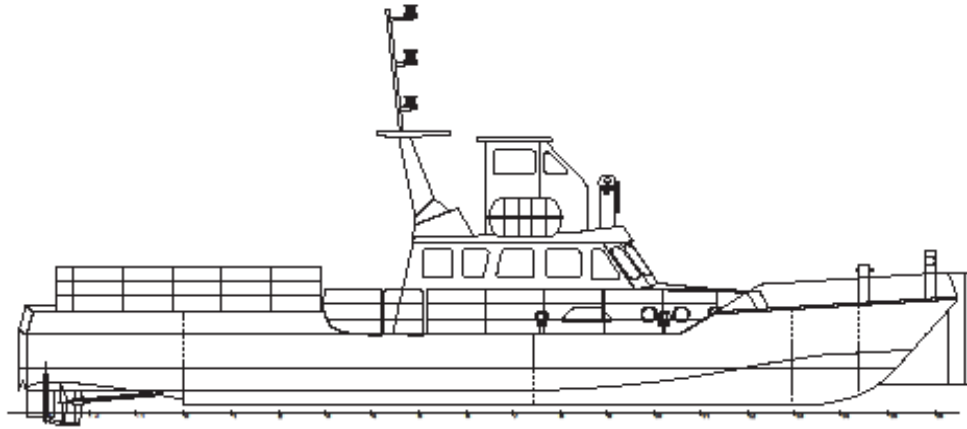

Main deck

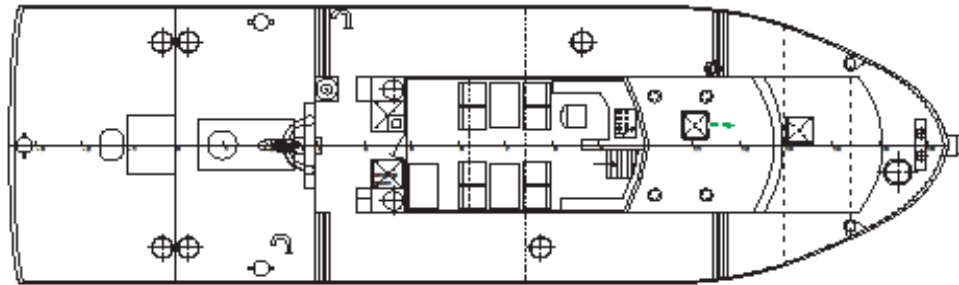

Below main deck

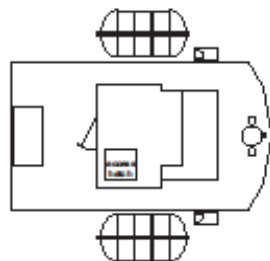
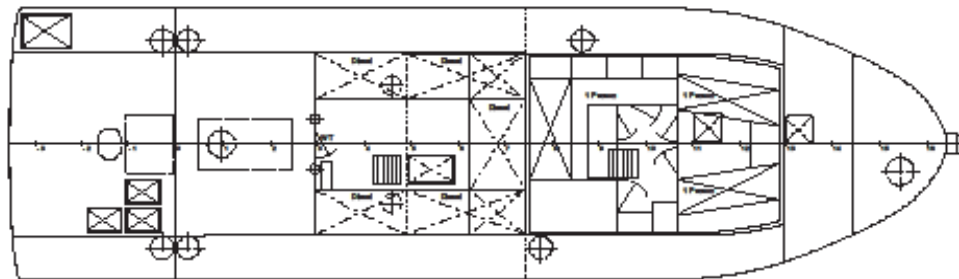

Upper deck

MAIN DIMENSIONS

LOA	19.80 m
Length	18.49 m
Breadth	6.00 m
Moulded Depth	1.54 m
Gross tonnage	51 t
Net tonnage	15 t

**All the details are believed to be correct but not guaranteed and owners reserve the right to amend them*