



Multicat "SURVEYOR"

492 KWT – Special service – Work boat

ENKA İNŞAAT VE SANAYİ A.Ş.

No.1, S. Zhanqabyluly, Bautino, 130502, Tupkaragan
Region, Mangistau Oblast, Republic of Kazakhstan
Phone: +7 72938 24 808, Fax: +7 72938 24 000
marine@enka.com
www.enka.com

SHIP SPECIFICATION "SURVEYOR"

CLASS AND FLAG DATA

Type	Work boat / special service
Year built / Shipyard	1990, Gorinchem
Class	BV
Class symbol	I • HULL • MACH Special service / Work boat / Coastal area
Flag	Kazakhstan
Port of registry	Aktau
Call sign	UOU
IMO number / or Class number	8882985

DIMENSIONS

Length (overall)	23.50 m
Length (between perpendicular)	22,29 m
Breadth (moulded)	10 m
Depth (moulded)	1,8 m
Draft (summer)	1,8 m
Minimal operational draft	1.4 m
Deadweight	102 tons
Registered gross tonnage	125

MACHINERIES

Main engines	3 pcs., Total 660 BHP (492 kWt) CAT-3306BDI-TA
Auxiliary diesel-generators	Jhon Deer 4045 DF158- 52kW
Emergency diesel-generator	HATZ DIESEL 4M40HZ , power – 24.0 kW
Bow thruster	215 HP CUMMINS N-855-M
CPP / FPP and Rudder(s)	Triple screw fixed pitch propeller in nozzles, rudders
Steering gear	Hydraulic pump for Steering gear – Vickers (A.Trinova USA) , model V20 63C , EN1000 , D/95/11

ANCHOR AND MOORING EQUIPMENT

Anchor windlass	1 pc., chamber pulley windlass powered with electricity
Anchors	1 pc., 250 kg
Chains (length, caliber)	length-100 meter, caliber-20
Capstan	1 pc., 2 tons capacity

TOWING AND ANCHOR HANDLING EQUIPMENT

AH winch / drum	Tow / Anchor handling, double drum winch SWL 15 tons
AH wire (main) dimensions and SWL / BL	200 m x 36 mm, MBL 910 kN
AH wire (spare) dimensions and SWL / BL	50m x 36 mm, MBL 92,1 tons
Bow roller	yes
AH pins	2 (bow)

TANKS FULL CAPACITIES

Fuel tanks	110 m ³
Fresh water tanks	6,1 m ³
Sewage water tanks	4,2 m ³
Oily bilge water tanks	4,2 m ³

TRANSFER RATES

Fuel	32 m ³ per hr
Fresh water	32 m ³ per hr
Sewage water	15 m ³ per hr
Oily bilge water	10 m ³ per hr

DECK CAPACITY

Deck strength	3 tons per m ²
Clear deck dimensions (L x B)	10 x 11 m
Clear deck area	112 m ²

**All the details are believed to be correct but not guaranteed and owners reserve the right to amend them*

SHIP SPECIFICATION "SURVEYOR"

DECK CRANE(S)

Manufacturer	HC 16052	H 54592
SWL	10t / 12,17m	2,8t / 11,3m
Location	Forward	Aft

PERFORMANCE

Maximum speed / consumption	8.7 kts / 2 tons
Economical speed / consumption	6 kts / 1,2 tons
Bollard pull	10,7 tone

NAVIGATION AND COMMUNICATION

GMDSS area	A1 + A2
INMARSAT station	SAILOR H2095C
Radar 1	FURUNO FR-7040D
AIS	NAUTICAST X-PACK DS
EPIRB	McMurdo Pains Wessex E3
Radar transponder	TronSART
VHF radio station	2x DSC FURUNO FM-8500
MF/HF radio station	FURUNO DSC – 60 ; FC – 11562-15
Two-way portable VHF	SIMRAD AXIS-50
	SAIT SRH-50
Magnetic compass	EURO 345
Auto pilot	DELTA 510 (out of order)
NAVTEX receiver	FURUNO NX-500
GPS receiver	FURUNO GP-32
Echo sounder	FURUNO FCV-620
Satcom	THURAVA SF2500

FIREFIGHTING EQUIPMENT AND POLLUTION PREVENTION EQUIPMENT

Portable fire extinguishers	10
Fire hoses and nozzles	2 Fire hoses, 2 fire hoses nozzles
Fire pump	WILO
Fixed fire-fighting system	CO ₂
Oil spill kit	1

LIFE-SAVING APPLIANCES

Inflatable life raft	1 x 25 , 1x 10
Life buoy	6
Life jacket	9 + additional if necessary
Immersion suit	7 + additional if necessary

ACCOMMODATION

Number of crew for safe operation / passengers	4 at twelve hours shift / 12 for short voyages only
Three-bed cabin	1
Mess room	1

TANK NAME

100% CAPACITY

Fuel supply tanks PS	55,79 m ³
Fuel supply tanks SS	55,238 m ³
Dirty oil tank PS	4,299 m ³
Sewage tank SS	4,299 m ³
Fuel day tank PS	3,819 m ³
Fuel day tank SS	3,819 m ³
Fresh water tank PS	3,053 m ³
Fresh water tank PS	3,053 m ³

**All the details are believed to be correct but not guaranteed and owners reserve the right to amend them*

SHIP SPECIFICATION "SURVEYOR"

MultiCat 2410

YN 2410

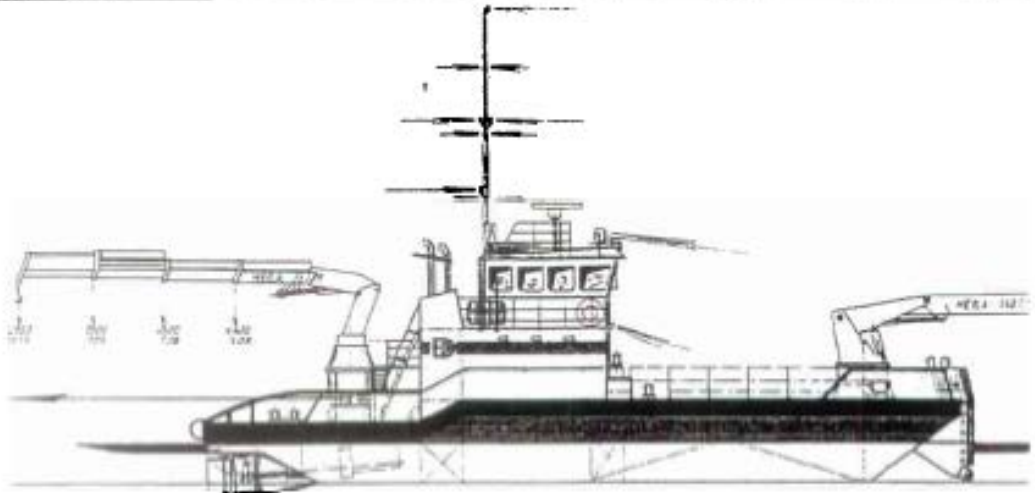

Maindeck

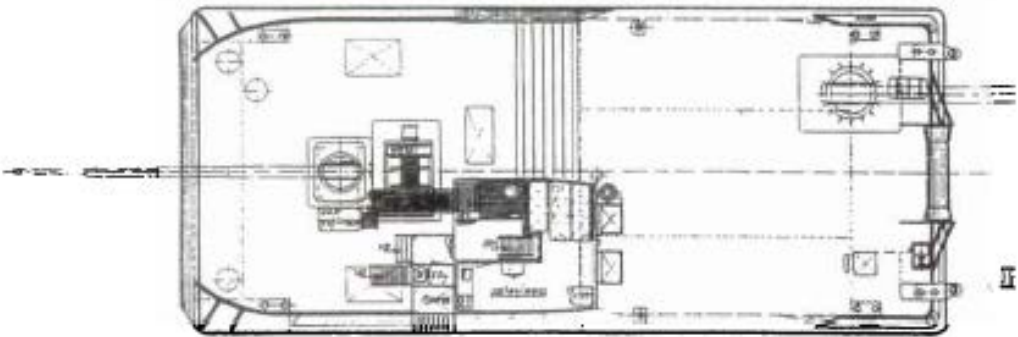

Below Maindeck

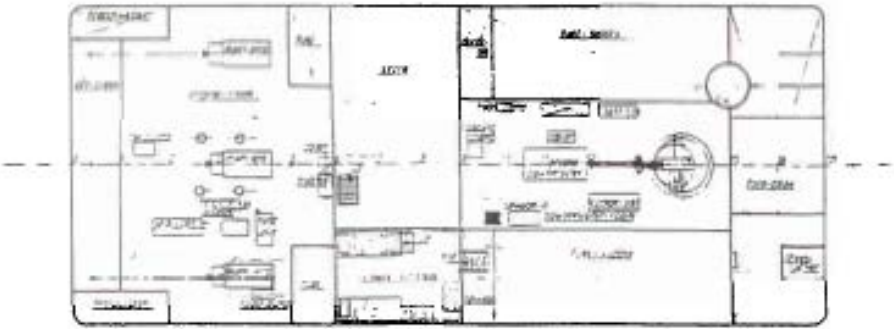

**All the details are believed to be correct but not guaranteed and owners reserve the right to amend them*